

# THE ROSLIN BEACH HOTEL

THORPE ESPLANADE, THORPE BAY,  
ESSEX, SS1 3BG

Do not scale this drawing. Work to figured dimensions only. This drawing is copyright of APS Designs and should only be reproduced with their express permission. Check all dimensions on site. Any discrepancies should be reported to APS Designs prior to commencement.

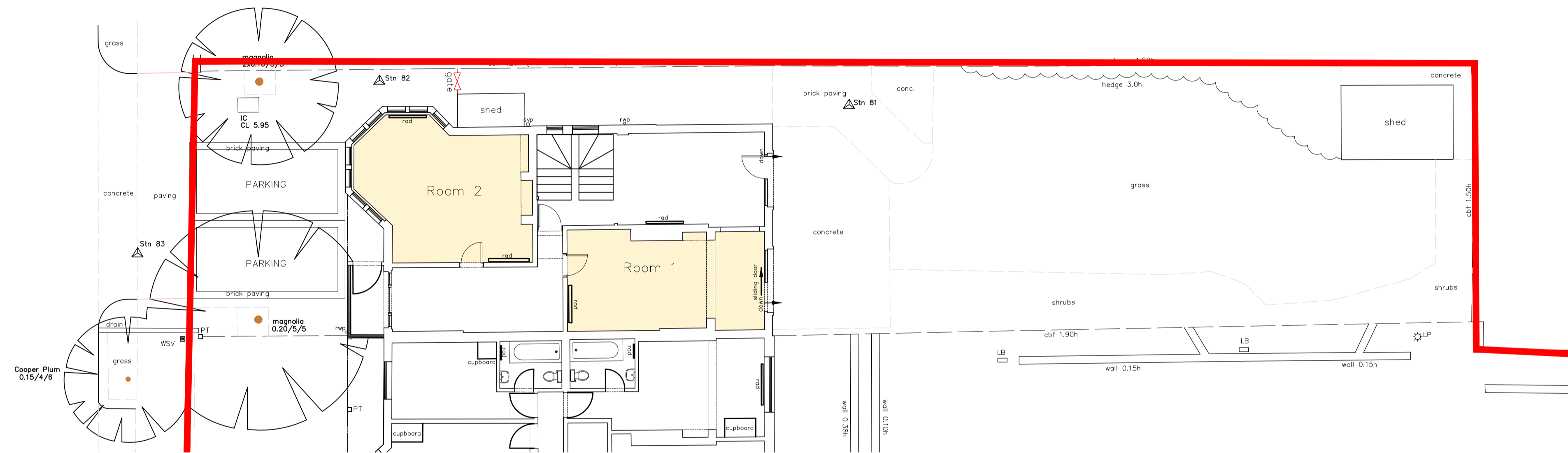

1 Proposed Ground Floor Plan

Scale: 1:100

REV A | 20.10.2016 | Amendments made in line with invalid letter dated 19.10.2016  
REVISION DATE AMENDMENT

**APS DESIGN ASSOCIATES LTD**  
ARCHITECTURAL DESIGNERS AND PLANNING CONSULTANTS

PROJECT STAGE: TOWN PLANNING  
DRAWN BY:  
DATE: Sept 2016  
CLIENT:

PROJECT: The Roslin Beach Hotel  
JOB NO: 2421  
DRAWING NO: 02b  
REVISION:

DRAWING TITLE: The Business Centre- Proposed Ground Floor plan  
SCALE: 1:100 @ A1

The Design Studio  
1 Cambridge Road (Rear)  
Nelson Street  
Southend-On-Sea  
Essex  
SS1 1ET

Tel: 01702 469 769 - 01702 337328  
Email: admin@apsdesignsuk.com  
design@apsdesignsuk.com  
planning@apsdesignsuk.com  
Website: www.apsdesignsuk.com